

WINDOWS

CRUSADER[®]

ELITE





DOUBLE HUNG

The most popular window style, featuring vertically moving sashes that operate easily and smoothly.



SLIDER

Features sashes that glide smoothly from side to side on brass rollers. Available in 2-Lite or 3-Lite configurations.



PICTURE

Non-operable, fixed window that offers clean aesthetic lines and allows ample natural light.



CASEMENT

Hinging at the top and bottom on stainless steel tracks, the window swings outward to open.



AWNING

Hinged on each side of the top on stainless steel tracks, the window swings outward at the bottom to open.

FEATURES

MANUFACTURED WITH CLEAN AESTHETIC LINES
& THE LATEST TECHNOLOGICAL INNOVATIONS.



LOW CONDUCTIVITY

ENERGY EFFICIENCY

PRODUCTION PRECISION

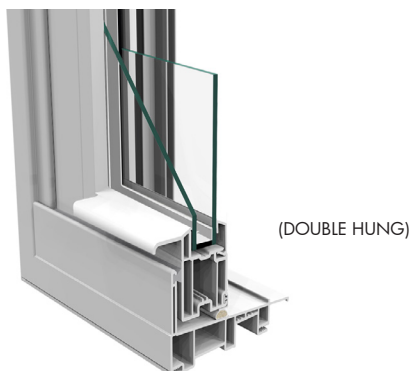

1 FUSION-WELDED SASHES & FRAME
Built from 100% virgin vinyl, to be exceptionally strong and durable, helping prevent air and water infiltration.

2 EXTERIOR BEVELED MAINFRAME
Provides contemporary beauty and style.

3 EXTRUDED LIFT & PULL RAILS
Built directly into sash for greater durability. No added or snap-in components.

4 STAINLESS STEEL CONSTANT FORCE BALANCE SYSTEM
Provides smooth and easy DOUBLE HUNG operation and never requires lubrication or adjustment.

5 DUAL-VENTILATION LATCHES
Limit the window opening to a set point during ventilation.

6 COMPOSITE INTERLOCK REINFORCEMENT
Composite reinforced, proprietary interlocking sashes provide increased strength where sashes meet.

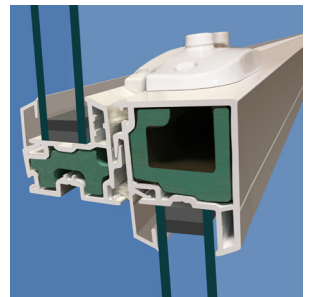

7 HEAVY-DUTY LOCK
Standard in this series. Heavy-duty zinc die-cast cam lock. LOCK/TILT LOCK UPGRADE AVAILABLE. See next page.



8 STAINLESS STEEL SPACER
Fully automated for condensation resistance and seal integrity. TPS SPACER UPGRADE AVAILABLE. See next page.

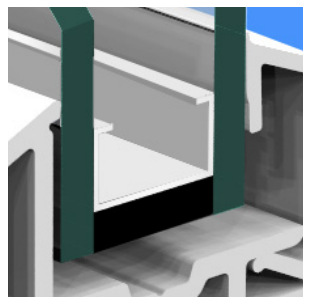

OPTIONS

COLOR

Due to effects of heat/light/age/printing process, samples shown here may vary slightly in color or sheen from actual materials.



GRIDS

COLONIAL (EQUAL LITES) QUEEN ANNE (PORTRAIT FRAME) DIAMOND (OBLIQUE LITES)

STYLE (DESIGN)



TYPE (MATERIAL)

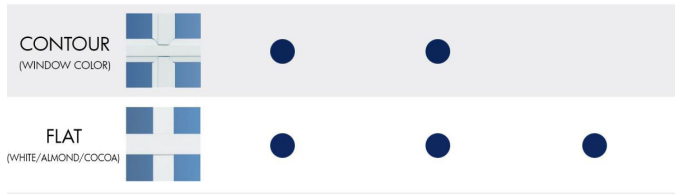

HARDWARE

LOCK/TILT LOCK UPGRADE

Available on Double Hung windows*, this lock upgrade provides one mechanism for locking and tilting the sash. Engineered to stand up to thousands of cycles, this upgraded lock eliminates the need for separate tilt latches, creating a smoother and more streamlined sash appearance.

*Not available for all widths. Units under 18" must feature standard hardware.

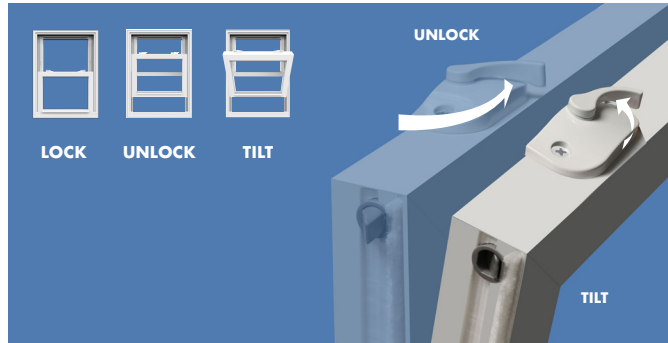

SPACER

TPS SPACER UPGRADE

A new state-of-the-art warm-edge spacer system that transfers less heat/cold than aluminum or steel. It expands and contracts with the change in temperature, providing an excellent seal.

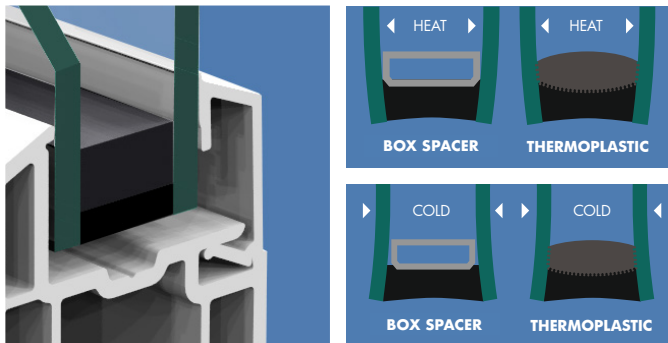

ADDITIONAL



INTEGRAL NAILING FIN

Specialized master frame with J-channel and nailing fin to facilitate installation with a better and more secure fit into your new home.



FACTORY MULLING

Northeast offers a zero-degree mulling system with factory sealed joints and steel plates at both the top and bottom of the window for added strength.



FULL SCREENS

Upgrade to be able to fully vent window. (Picture: no screen; Casement/Awning; standard full screen.)



CUSTOM SHAPES

For the ultimate in style, design and individuality, Northeast offers a full line of specialized window shapes and sizes, custom made to fit your home's unique character.



ORIEL STYLE/COTTAGE CONFIGURATIONS

Oriel style windows feature unequal sash configurations. This allows for a distinctive, customized look that will set your windows apart.



SPECIALTY GLASS**

Tempered safety glass is available for additional privacy and peace of mind.

**Glass privacy ratings range from 1 (least) to 9 (most).

PERFORMANCE

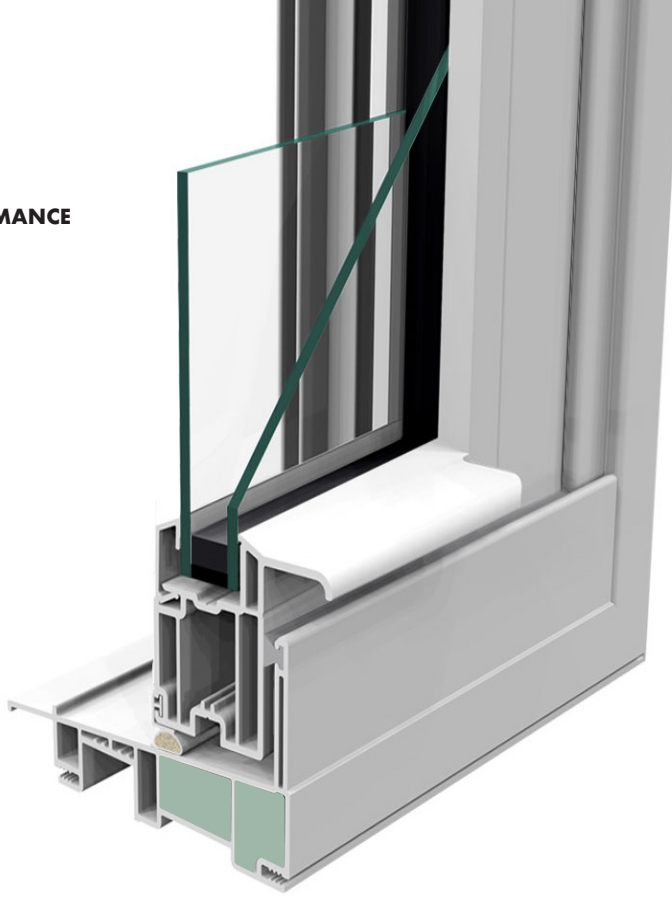

FRAME FOAM

The hollows inside the vinyl master frame are injected with polyurethane foam to reduce thermal conductivity and help your windows operate at peak thermal efficiency year round.

GLASS PACKAGES

PACKAGE RATINGS ACHIEVED WITH FRAME FOAM & TPS

U - U-FACTOR **S** - SOLAR HEAT GAIN COEFFICIENT **V** - VISIBLE TRANSMITTANCE **A** - AIR LEAKAGE
 NFRC® labels refer to whole-window performance, not just the insulated glass unit.

LOW-E/ARGON

SB60 | ARG90 | CLR | TPS | NO GRIDS

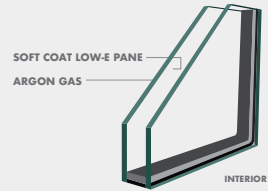

U	S	V	A
.27	.29	.53	≤.3

SOLAR LOW-E/ARGON

SB70 | ARG90 | CLR | TPS | NO GRIDS

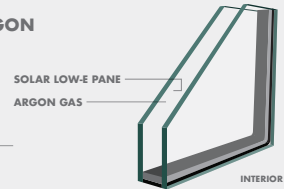

U	S	V	A
.26	.20	.47	≤.3

THERMAL(SFC 4)/LOW-E/ARGON

SB60 | ARG90 | CLR | TPS | NO GRIDS

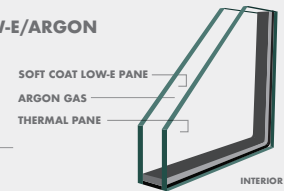

U	S	V	A
.23	.28	.48	≤.3

THERMAL(SFC 4)/SOLAR LOW-E/ARGON

SB70 | ARG90 | CS73 | TPS | NO GRIDS

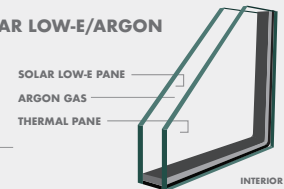

U	S	V	A
.23	.19	.43	≤.3

COMPARE \approx AIR INFILTRATION

THE LOWER THE **CFM** RATING: • LESS OUTSIDE AIR LEAKAGE INSIDE • FEWER DRAFTS • GREATER COMFORT • FEWER HEATING & COOLING NEEDS, LOWER EXPENSES • SMALLER CARBON FOOTPRINT

INDUSTRY STANDARD

AIR LEAKAGE:

2.25

GALLONS OF AIR



.30 CFM

Air Leakage

TRADITIONAL WOOD RESIDENTIAL

DOUBLE HUNG WINDOWS

1.725

GALLONS OF AIR



.23 CFM

Air Leakage

(Industry Average Range: 0.12 CFM - 0.30 CFM**)

TRADITIONAL VINYL RESIDENTIAL HIGH-PERFORMANCE

DOUBLE HUNG WINDOWS

1.125

GALLONS OF AIR



.15 CFM

Air Leakage

(Industry Average Range: 0.11 CFM - 0.21 CFM**)

CRUSADER® ELITE

DOUBLE HUNG WINDOWS

.23

GALLONS OF AIR



.03 CFM

Air Leakage

(More than twice as airtight as Traditional Wood Residential)

*INDUSTRY STANDARD: The Fenestration and Glazing Industry Alliance (FGIA) set the industry standard for maximum allowable air infiltration at 0.30 CFM (cubic feet per minute) during a 25 MPH wind. This is equal to 2.25 gallons of air leaking through the window every minute! **References valid as of Oct. 1, 2020, based on our competitor's websites and independent testing.

MAKE YOUR DREAMS COME THROUGH.



215.535.7110 • 4280 Aramingo Avenue • Philadelphia, PA 19124-5007 • **NBPwindows.com**

Northeast Building Products, LLC. and Crusader® Elite Windows are registered trademarks. All Rights Reserved.

